

ALIGNMENT TOOLS

SPECIAL HEX-TIP TOOL

Hex: .010"

On one end, flat tip (0.025" thick x 0.10" wide) is followed by a 0.10" hex. The opposite end is an undercut 0.10" hex. Overall length, 5". Replaces type 8606.

No. 63-8606

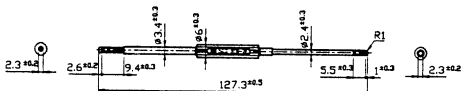

DOUBLE END HEX TOOL

Hex: .125"

One end is an under cut .125" and other is a .125" hex preceded by a flat (.025" thick x .10" wide) blade. Entire tool is molded Nylon. Replaces type 9091.

No. 63-9091

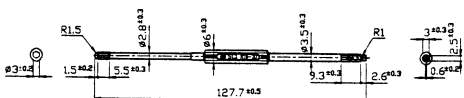

SCREWDRIVER-HEX COMBINATION TOOL

Hex: .078"

One end is an undercut 0.078" hex tip and other is a screwdriver style tip that is 0.10" in diameter and tapers to 0.015" thick. Overall length: 5-5/16", molded Nylon. Replaces type 9304.

No. 63-9304

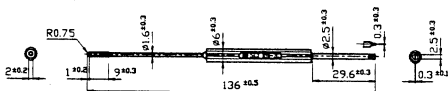

TECH'S ALIGNMENT TOOL KIT

A general purpose kit containing four tools with a variety of needed tips. Includes tools for most common ferrite core adjustments used in today's circuits. Supplied in a plastic pouch. Contains tool Nos.: 63-8603, 63-9301, 63-9442, and 63-9297.

No. 63-8420

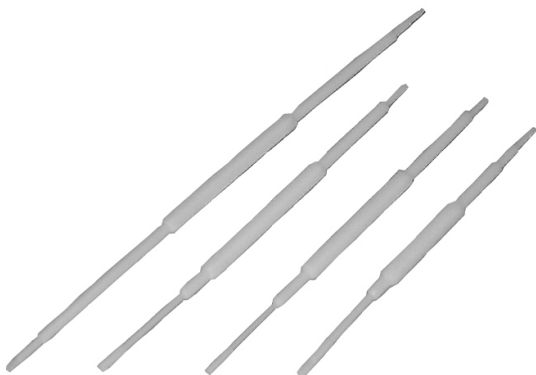

TELEVISION ALIGNMENT TOOL SET

Kit contains the five most commonly needed tools for television service. Also included is an extender that may be used as an extension handle when a longer reach tool is needed. Kit is supplied in a segmented pouch to keep tools together.

Contains: 63-9300 63-8606
63-8282 63-9091
63-9304 Extender

No. 63-8454



SQUARE and HEX ALIGNMENT TOOL

Square: .060" Hex: 0.10" & Blade

A double-ended, molded nylon tool: overall length is 4-3/4" One end is a square .060" tip with protruding blade from a 0.10" hex. The other end is a flat (.039" thick) blade which is followed by an undercut .10" hex. A tool frequently needed in color copier maintenance

No. 63-9442

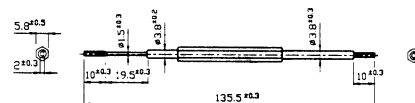

DOUBLE ENDED HEX TOOL

Hex: 0.078"

Undercut .078" hex on one end and on the other the hex is stopped with a larger diameter shaft. Overall length is 5.33". Molded Nylon.

No. 63-9301

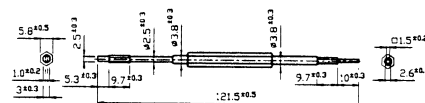

DOUBLE ENDED HEX TOOL

Hex: 0.10" & .087"

A dual ended tool with an undercut 0.10" hex on one end and a standard .087" (for 2.2mm cores) hex on the other. Overall length is 5.6". Molded Nylon.

No. 63-8603

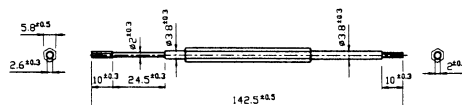

SCREWDRIVER-HEX COMBINATION TOOL

Hex: .092"

One end is an undercut 0.092" hex tip and other is a screwdriver style tip that is 0.10" in diameter and tapers to 0.015" thick. Overall length: 5-5/16", molded Nylon. Replaces type 8282.

No. 63-8282

